

© Presentation

### KAWNEER AN ARCONIC COMPANY

555 Guthridge Ct.  
Technology Park/Atlanta  
Norcross, GA 30092 USA  
Tel: +1 770 449 5555

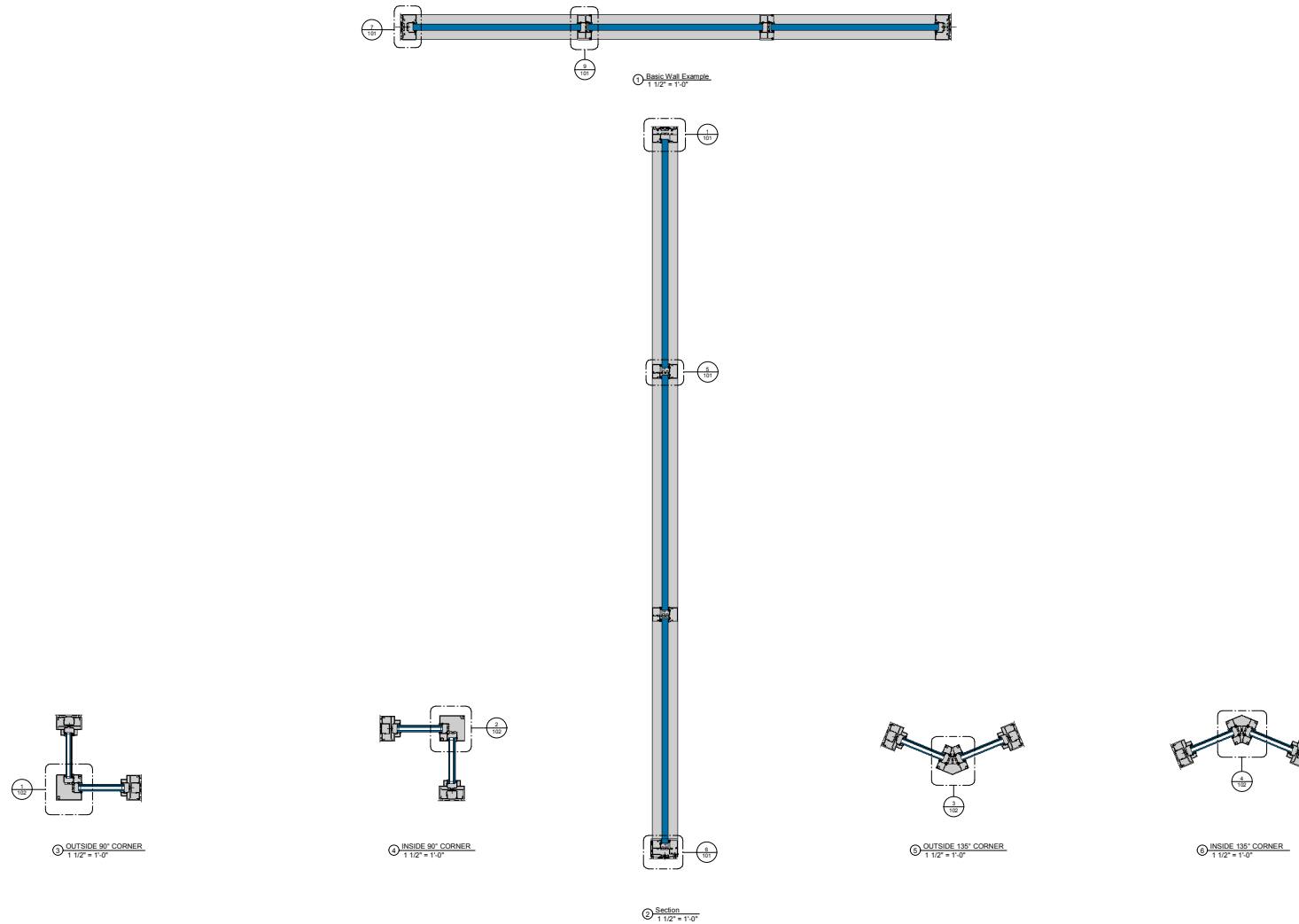

**KAWNEER AN ARCONIC COMPANY**

555 Guthridge Ct.  
Technology Park/Atlanta  
Norcross, GA 30092 USA  
Tel: +1 770 449 5555

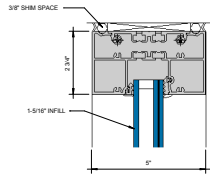

① STANDARD HEAD  
6" = 1'-0"

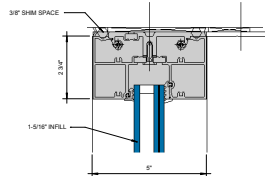

② STANDARD HEAD WITH STRAP ANCHOR  
6" = 1'-0"

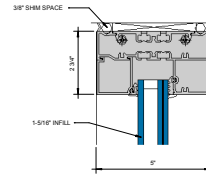

③ OPTIONAL HEAD  
6" = 1'-0"

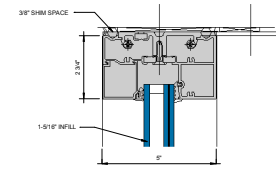

④ OPTIONAL HEAD WITH STRAP ANCHOR  
6" = 1'-0"

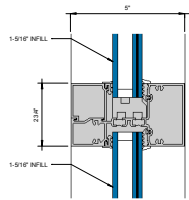

⑤ HORIZONTAL  
6" = 1'-0"

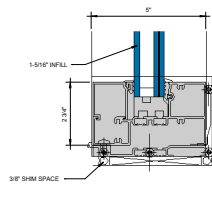

⑥ SILL  
6" = 1'-0"

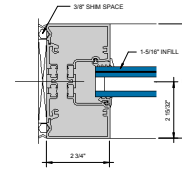

⑦ JAMB  
6" = 1'-0"

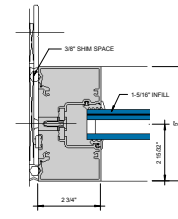

⑧ JAMB WITH STRAP ANCHOR  
6" = 1'-0"

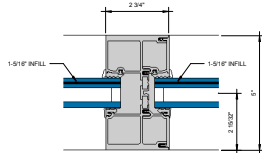

⑨ 3 PIECE VERTICAL  
6" = 1'-0"

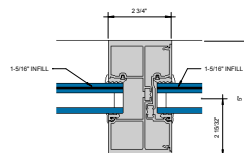

⑩ 2 PIECE VERTICAL  
6" = 1'-0"

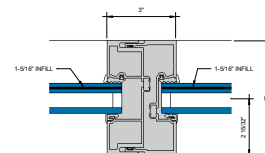

⑪ EXPANSION MULLION  
6" = 1'-0"

### KAWNEER AN ARCONIC COMPANY

555 Guthridge Ct.  
Technology Park/Atlanta  
Norcross, GA 30092 USA  
Tel: +1 770 449 5555

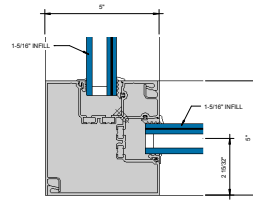

① OUTSIDE 90° CORNER  
6" = 1'-0"

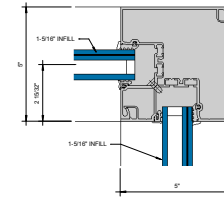

② INSIDE 90° CORNER  
6" = 1'-0"

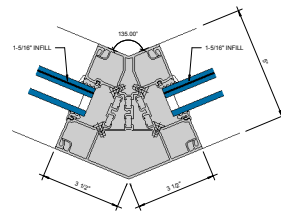

③ OUTSIDE 135° CORNER  
6" = 1'-0"

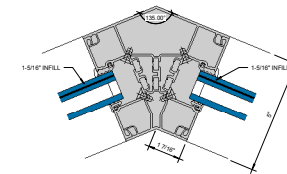

④ INSIDE 135° CORNER  
6" = 1'-0"

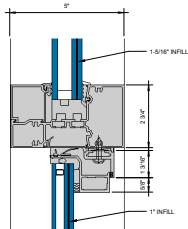

① HEAD AT HORIZONTAL PROJECT-OUT  
6" = 1'-0"

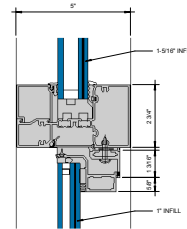

② HEAD AT HORIZONTAL OUTSWING  
CASEMENT  
6" = 1'-0"

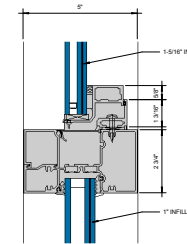

③ SILL AT HORIZONTAL  
6" = 1'-0"

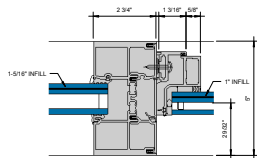

④ JAMB AT 3 PIECE VERTICAL MULLION  
(SHALLOW POCKET SIDE)  
6" = 1'-0"

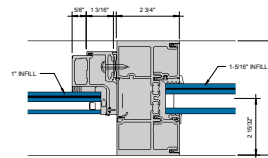

⑤ JAMB AT 3 PIECE VERTICAL MULLION  
(DEEP POCKET SIDE)  
6" = 1'-0"

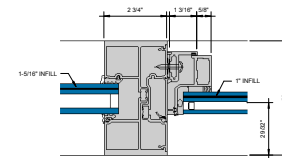

⑥ JAMB AT 2 PIECE VERTICAL MULLION  
(SHALLOW POCKET SIDE)  
6" = 1'-0"

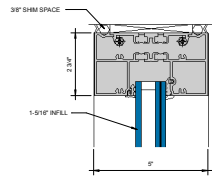

① STANDARD HEAD  
Ø = 1'-0"

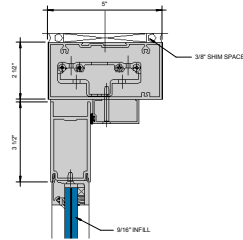

② COC HEADER OFFSET PIVOT  
Ø = 1'-0"

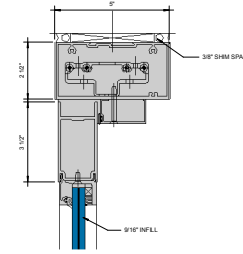

③ COC HEADER BUTT HINGE  
Ø = 1'-0"

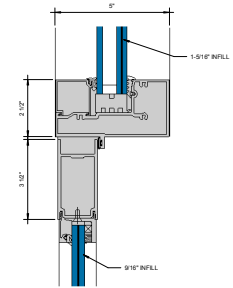

④ TRANSOM BAR  
Ø = 1'-0"

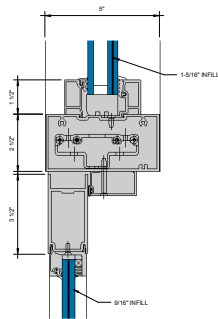

⑤ COC TRANSOM BAR OFFSET PIVOT  
Ø = 1'-0"

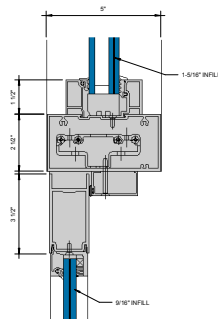

⑥ COC TRANSOM BAR BUTT HINGE  
Ø = 1'-0"

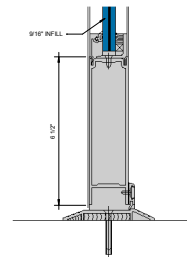

⑦ BOTTOM RAIL  
Ø = 1'-0"

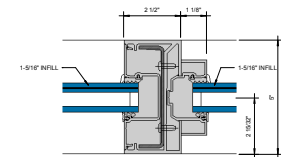

⑧ ENTRANCE - DOOR JAMB AT TRANSOM AREA WITH SIDELITE OR POCKET AREA  
Ø = 1'-0"

### KAWNEER AN ARCONIC COMPANY

555 Guthridge Ct.  
Technology Park/Atlanta  
Norcross, GA 30092 USA  
Tel: +1 770 449 5555

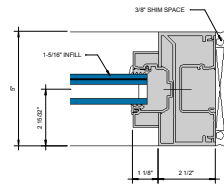

ENTRANCE - DOOR JAMB AT TRANSOM AREA WITH POCKET INSERT  
①  
6" = 1'-0"

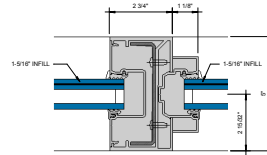

ENTRANCE - 2.75' DOOR JAMB AT TRANSOM AREA WITH SIDELITE OR POCKET INSERT  
②  
6" = 1'-0"

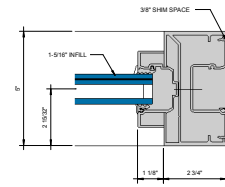

ENTRANCE - 2.75' DOOR JAMB AT TRANSOM AREA WITH POCKET INSERT  
③  
6" = 1'-0"

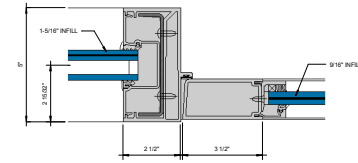

ENTRANCE - DOOR JAMB SINGLE ACTING WITH OFFSET PIVOT OR BUTT HINGE  
④  
6" = 1'-0"

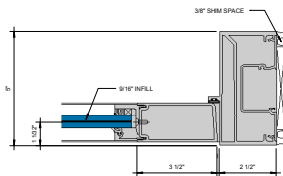

ENTRANCE - MEETING STILE  
⑤  
6" = 1'-0"

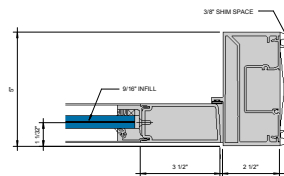

ENTRANCE - DOOR JAMB SINGLE ACTING WITH OFFSET PIVOT OR BUTT HINGE  
⑥  
6" = 1'-0"

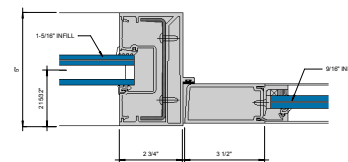

ENTRANCE - 2.75' DOOR JAMB SINGLE ACTING WITH OFFSET PIVOT OR BUTT HINGE  
⑦  
6" = 1'-0"

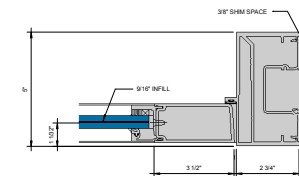

ENTRANCE - 2.75' DOOR JAMB - SINGLE ACTING WITH OFFSET PIVOT OR BUTT HINGE  
⑧  
6" = 1'-0"

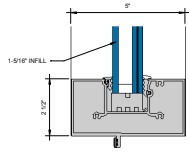

① 1 PIECE HEADER OR TRANSOM BAR WITH INFILL  
9" = 1'-0"

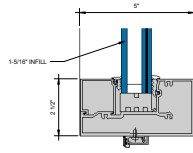

② 2 PIECE HEADER OR TRANSOM BAR  
9" = 1'-0"

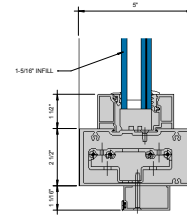

③ HW COC TRANSOM BAR OFFSET PIVOT  
9" = 1'-0"

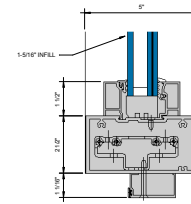

④ HW COC TRANSOM BAR BUTT HINGE  
9" = 1'-0"

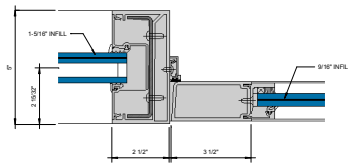

⑤ OPTIONAL DOOR JAMB  
9" = 1'-0"

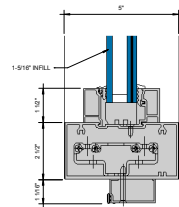

⑥ COC TRANSOM BAR OFFSET PIVOT  
9" = 1'-0"

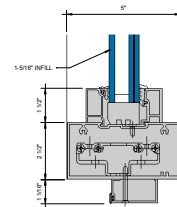

⑦ COC TRANSOM BAR BUTT HINGE  
9" = 1'-0"



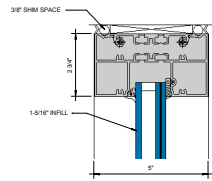

① STANDARD HEAD  
6" = 1'-0"

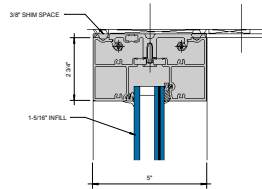

② STANDARD HEAD WITH STRAP ANCHOR  
6" = 1'-0"

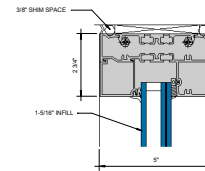

③ OPTIONAL HEAD  
6" = 1'-0"

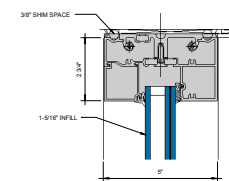

④ OPTIONAL HEAD WITH STRAP ANCHOR  
6" = 1'-0"

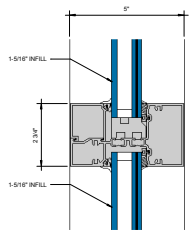

⑤ HORIZONTAL  
6" = 1'-0"

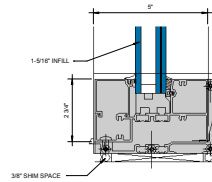

⑥ SILL  
6" = 1'-0"

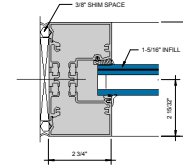

⑦ JAMB  
6" = 1'-0"

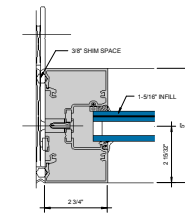

⑧ JAMB WITH STRAP ANCHOR  
6" = 1'-0"

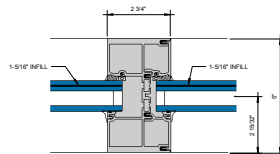

⑨ 3-PIECE VERTICAL  
6" = 1'-0"

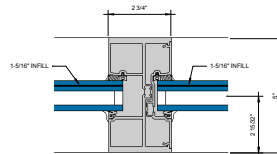

⑩ 2-PIECE VERTICAL  
6" = 1'-0"

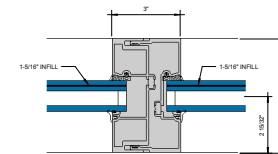

⑪ EXPANSION MULLION  
6" = 1'-0"

### KAWNEER AN ARCONIC COMPANY

555 Guthridge Ct.  
Technology Park/Atlanta  
Norcross, GA 30092 USA  
Tel: +1 770 449 5555

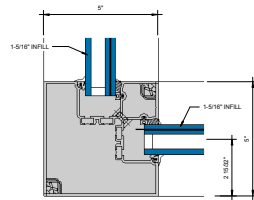

① OUTSIDE 90° CORNER  
6" = 1'-0"

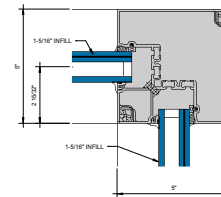

② INSIDE 90° CORNER  
6" = 1'-0"

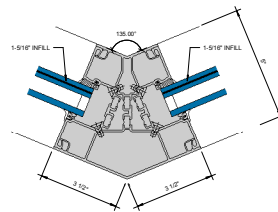

③ OUTSIDE 135° CORNER  
6" = 1'-0"

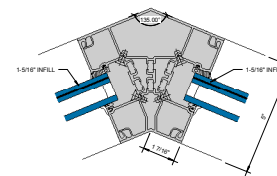

④ INSIDE 135° CORNER  
6" = 1'-0"

### KAWNEER AN ARCONIC COMPANY

555 Guthridge Ct.  
Technology Park/Atlanta  
Norcross, GA 30092 USA  
Tel: +1 770 449 5555

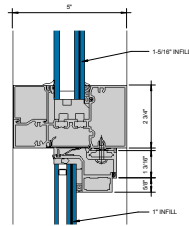

① HEAD AT HORIZONTAL PROJECT OUT  
6" = 1'-0"

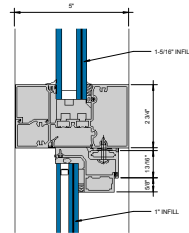

② HEAD AT HORIZONTAL OUTSWING  
CASEMENT  
6" = 1'-0"

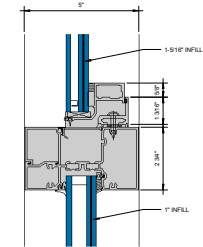

③ SILL AT HORIZONTAL  
6" = 1'-0"

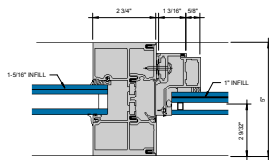

JAMB AT 3 PIECE VERTICAL MULLION  
④ (SHALLOW POCKET SIDE)  
6" = 1'-0"

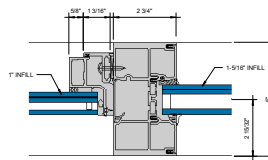

JAMB AT 3 PIECE VERTICAL MULLION  
⑤ (DEEP POCKET SIDE)  
6" = 1'-0"

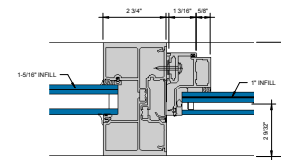

JAMB AT 2 PIECE VERTICAL MULLION  
⑥ (SHALLOW POCKET SIDE)  
6" = 1'-0"

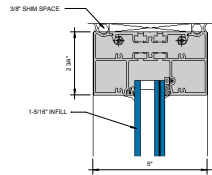

① STANDARD HEAD  
6" = 1'-0"

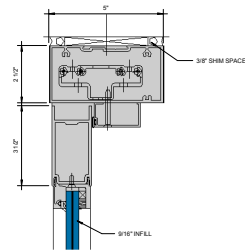

② COC HEADER OFFSET PIVOT  
6" = 1'-0"

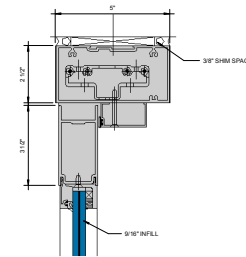

③ COC HEADER BUTT HINGE  
6" = 1'-0"

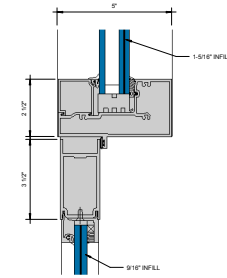

④ TRANSOM BAR  
6" = 1'-0"

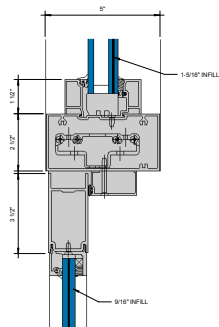

⑤ COC TRANSOM BAR OFFSET PIVOT  
6" = 1'-0"

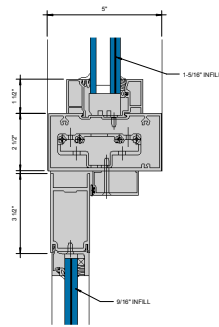

⑥ COC TRANSOM BAR BUTT HINGE  
6" = 1'-0"

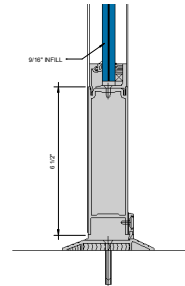

⑦ BOTTOM RAIL  
6" = 1'-0"

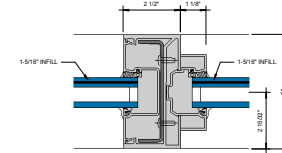

⑧ ENTRANCE - DOOR JAMB AT TRANSOM AREA WITH SIDELITE OR POCKET AREA  
6" = 1'-0"

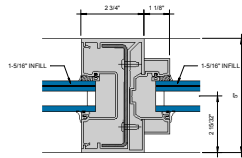

ENTRANCE - 2.75" DOOR JAMB AT TRANSOM AREA WITH SIDELITE OR POCKET INSERT  
 ① HINGE  
 b" = 1'-0"

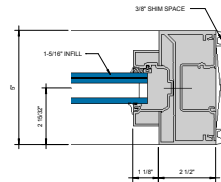

ENTRANCE - DOOR JAMB AT TRANSOM AREA WITH POCKET INSERT  
 ② HINGE  
 b" = 1'-0"

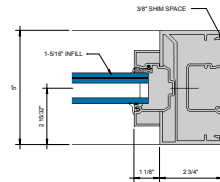

ENTRANCE - 2.75" DOOR JAMB AT TRANSOM AREA WITH POCKET INSERT  
 ① HINGE  
 b" = 1'-0"

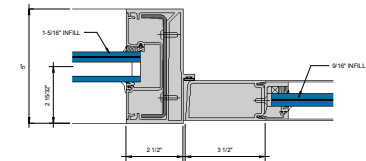

ENTRANCE - 2.75" DOOR JAMB - SINGLE ACTING WITH OFFSET PIVOT OR BUTT HINGE  
 ③ HINGE  
 b" = 1'-0"

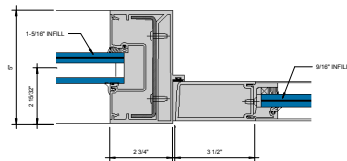

ENTRANCE - 2.75" DOOR JAMB - SINGLE ACTING WITH OFFSET PIVOT OR BUTT HINGE  
 ④ HINGE  
 b" = 1'-0"

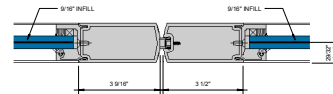

ENTRANCE - MEETING STILE  
 ⑤ HINGE  
 b" = 1'-0"

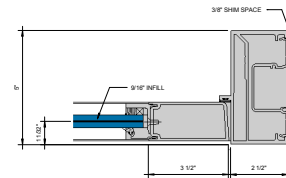

ENTRANCE - 2.75" DOOR JAMB SINGLE ACTING WITH OFFSET PIVOT OR BUTT HINGE  
 ⑦ HINGE  
 b" = 1'-0"

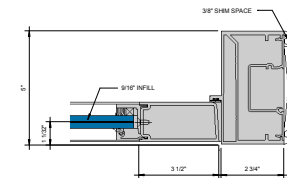

ENTRANCE - 2.75" DOOR JAMB - SINGLE ACTING WITH OFFSET PIVOT OR BUTT HINGE  
 ⑧ HINGE  
 b" = 1'-0"

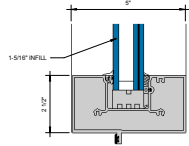

1 PIECE HEADER OR TRANSOM BAR WITH FIN  
6" = 1'-0"

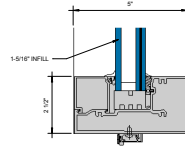

2 PIECE HEADER OR TRANSOM BAR  
6" = 1'-0"

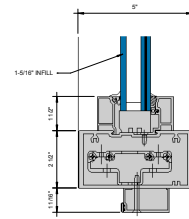

HW COC TRANSOM BAR OFFSET PIVOT  
6" = 1'-0"

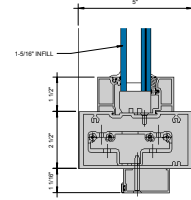

HW COC TRANSOM BAR BUTT HINGE  
6" = 1'-0"

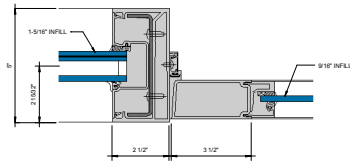

OPTIONAL DOOR JAMB  
6" = 1'-0"

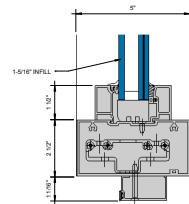

COC TRANSOM BAR OFFSET PIVOT  
6" = 1'-0"

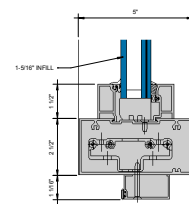

COC TRANSOM BAR BUTT HINGE  
6" = 1'-0"

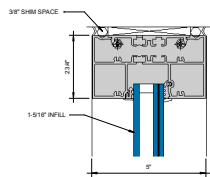

① STANDARD HEAD  
6" = 1'-0"

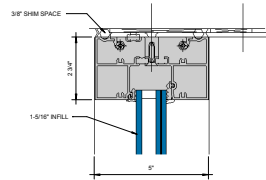

② STANDARD HEAD WITH STRAP ANCHOR  
6" = 1'-0"

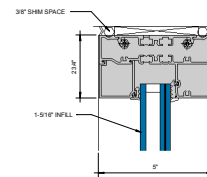

③ OPTIONAL HEAD  
6" = 1'-0"

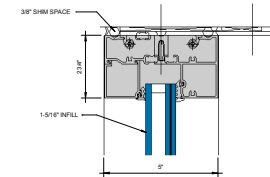

④ OPTIONAL HEAD WITH STRAP ANCHOR  
6" = 1'-0"

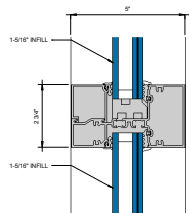

⑤ HORIZONTAL  
6" = 1'-0"

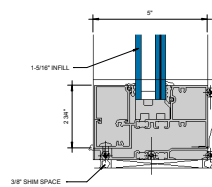

⑥ SILL  
6" = 1'-0"

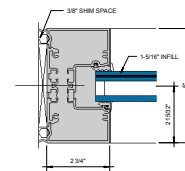

⑦ JAMB  
6" = 1'-0"

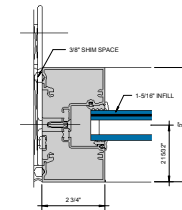

⑧ JAMB WITH STRAP ANCHOR  
6" = 1'-0"

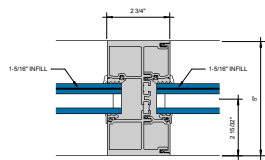

⑨ 3 PIECE VERTICAL  
6" = 1'-0"

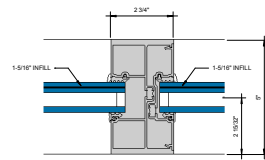

⑩ 2 PIECE VERTICAL  
6" = 1'-0"

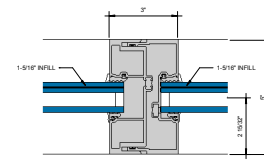

⑪ EXPANSION MULLION  
6" = 1'-0"

### KAWNEER AN ARCONIC COMPANY

555 Guthridge Ct.  
Technology Park/Atlanta  
Norcross, GA 30092 USA  
Tel: +1 770 449 5555

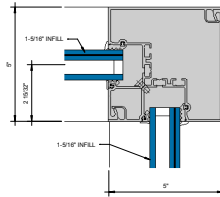

① INSIDE 90° CORNER  
6" = 1'-0"

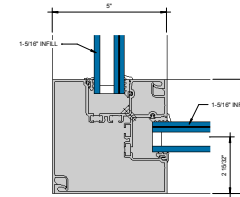

② OUTSIDE 90° CORNER  
6" = 1'-0"

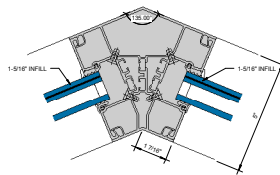

③ INSIDE 135° CORNER  
6" = 1'-0"

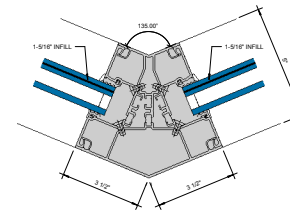

④ OUTSIDE 135° CORNER  
6" = 1'-0"



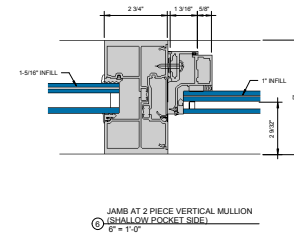
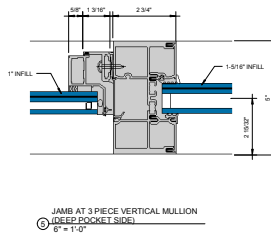
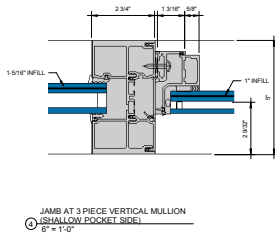
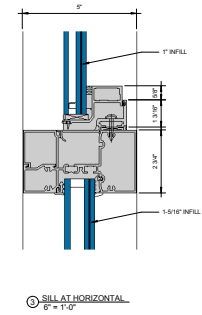
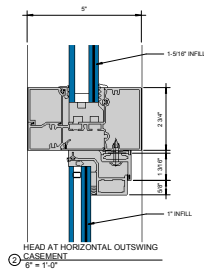
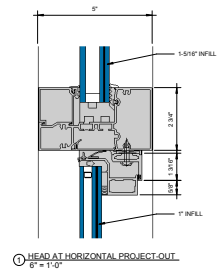

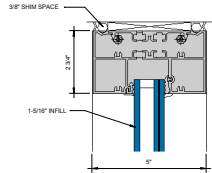

① STANDARD HEAD  
6" = 1'-0"

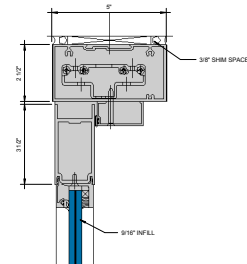

② COC HEADER OFFSET PIVOT  
6" = 1'-0"

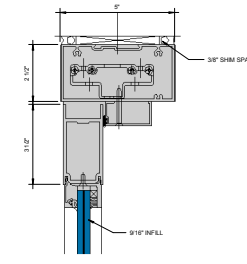

③ COC HEADER BUTT HINGE  
6" = 1'-0"

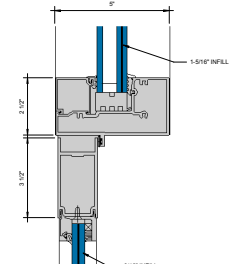

④ TRANSOM BAR  
6" = 1'-0"

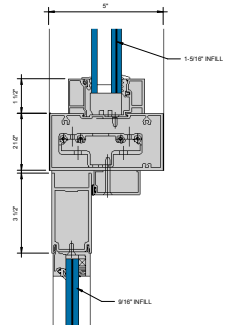

⑤ COC TRANSOM BAR OFFSET PIVOT  
6" = 1'-0"

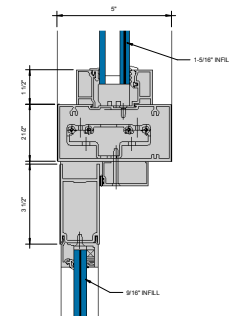

⑥ COC TRANSOM BAR BUTT HINGE  
6" = 1'-0"

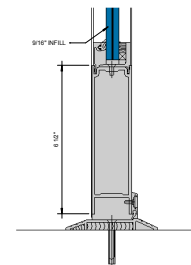

⑦ BOTTOM RAIL  
6" = 1'-0"

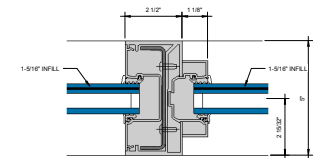

ENTRANCE - DOOR JAMB AT TRANSOM AREA WITH SIDELITE OR POCKET  
⑧ INSERT  
6" = 1'-0"

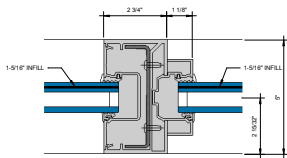

ENTRANCE - 2.75" DOOR JAMB AT TRANSOM AREA WITH SIDELITE OR POCKET INSERT  
⑨ POCKET INSERT  
6" = 1'-0"

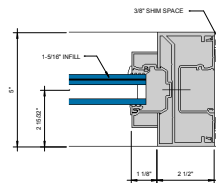

ENTRANCE - DOOR JAMB AT TRANSOM AREA WITH POCKET INSERT  
⑩ AREA WITH POCKET INSERT  
6" = 1'-0"

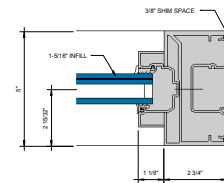

ENTRANCE - 2.75" DOOR JAMB AT TRANSOM AREA WITH POCKET INSERT  
⑪ TRANSOM AREA WITH POCKET INSERT  
6" = 1'-0"

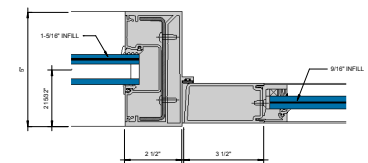

ENTRANCE - DOOR JAMB SINGLE ACTING WITH OFFSET PIVOT OR BUTT HINGE  
⑫ HINGE  
6" = 1'-0"

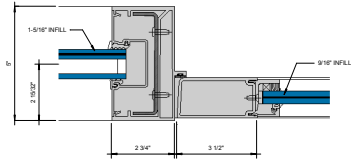

ENTRANCE - 2 7/8\"/>

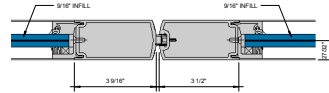

ENTRANCE - MEETING STILE  
 $\phi = 1.0"$

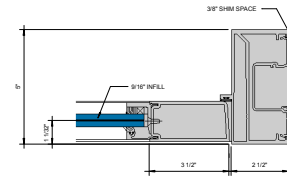

ENTRANCE - DOOR JAMB SINGLE  
 ACTING WITH OFFSET PIVOT OR BUTT  
 HINGE  
 $\phi = 1.0"$

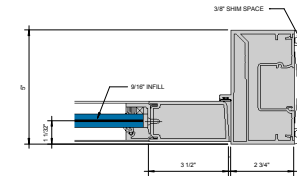

ENTRANCE - 2 7/8\"/>

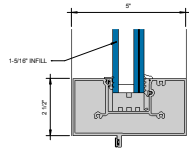

1 PIECE HEADER OR TRANSOM BAR  
WITH FIN  
6" = 1'-0"

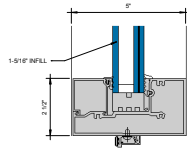

2 PIECE HEADER OR TRANSOM BAR  
6" = 1'-0"

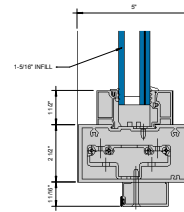

W/ LOC TRANSOM BAR OFFSET PIVOT  
6" = 1'-0"

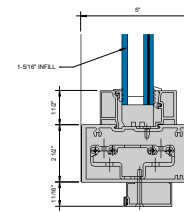

W/ LOC TRANSOM BAR BUTT HINGE  
6" = 1'-0"

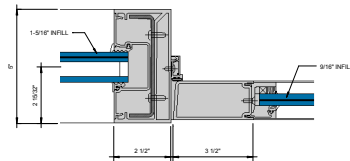

OPTIONAL DOOR JAMB  
6" = 1'-0"

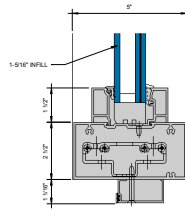

LOC TRANSOM BAR OFFSET PIVOT  
6" = 1'-0"

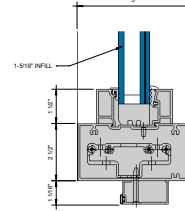

LOC TRANSOM BAR BUTT HINGE  
6" = 1'-0"

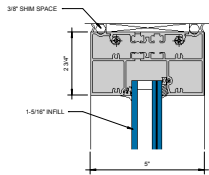

① STANDARD HEAD  
6" = 1'-0"

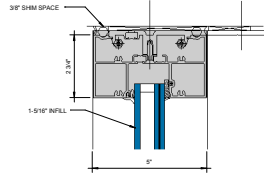

② STANDARD HEAD WITH STRAP ANCHOR  
6" = 1'-0"

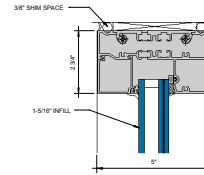

③ OPTIONAL HEAD  
6" = 1'-0"

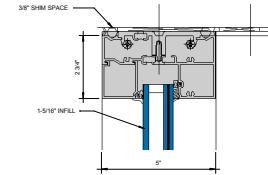

④ OPTIONAL HEAD WITH STRAP ANCHOR  
6" = 1'-0"

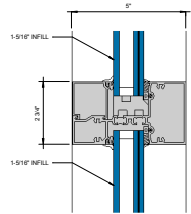

⑤ HORIZONTAL  
6" = 1'-0"

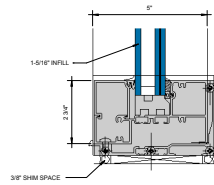

⑥ SILL  
6" = 1'-0"

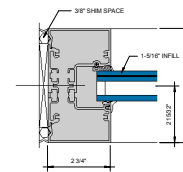

⑦ JAMB  
6" = 1'-0"

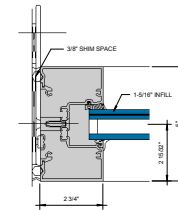

⑧ JAMB WITH STRAP ANCHOR  
6" = 1'-0"

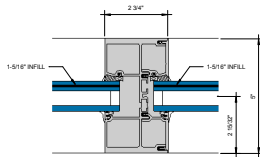

⑨ 3-PIECE VERTICAL  
6" = 1'-0"

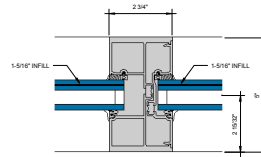

⑩ 2-PIECE VERTICAL  
6" = 1'-0"

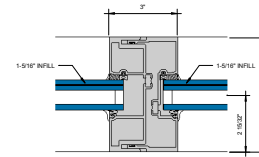

⑪ EXPANSION MULLION  
6" = 1'-0"

### KAWNEER AN ARCONIC COMPANY

555 Guthridge Ct.  
Technology Park/Atlanta  
Norcross, GA 30092 USA  
Tel: +1 770 449 5555

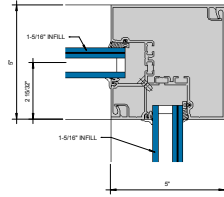

① INSIDE 90° CORNER  
6" = 1'-0"

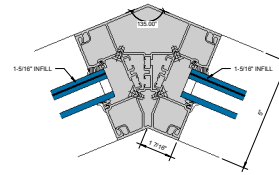

② INSIDE 135° CORNER  
6" = 1'-0"

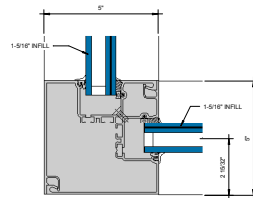

③ OUTSIDE 90° CORNER  
6" = 1'-0"

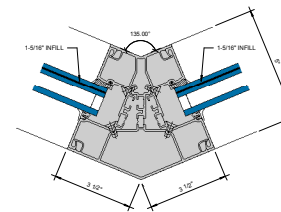

④ OUTSIDE 135° CORNER  
6" = 1'-0"

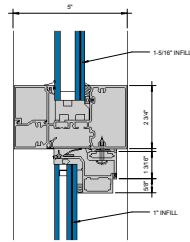

① HEAD AT HORIZONTAL PROJECT-OUT  
6" = 1'-0"

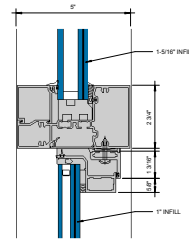

② HEAD AT HORIZONTAL OUTSWING  
CASEMENT  
6" = 1'-0"

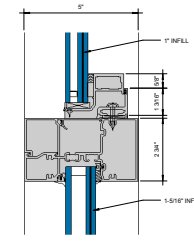

③ SILL AT HORIZONTAL  
6" = 1'-0"

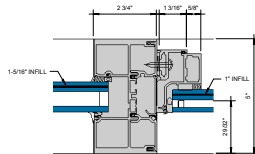

④ JAMB AT 3 PIECE VERTICAL MULLION  
(SHALLOW POCKET SIDE)  
6" = 1'-0"

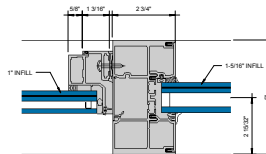

⑤ JAMB AT 3 PIECE VERTICAL MULLION  
(DEEP POCKET SIDE)  
6" = 1'-0"

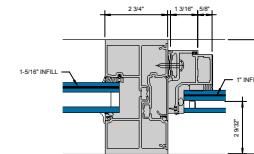

⑥ JAMB AT 2 PIECE VERTICAL MULLION  
(SHALLOW POCKET SIDE)  
6" = 1'-0"

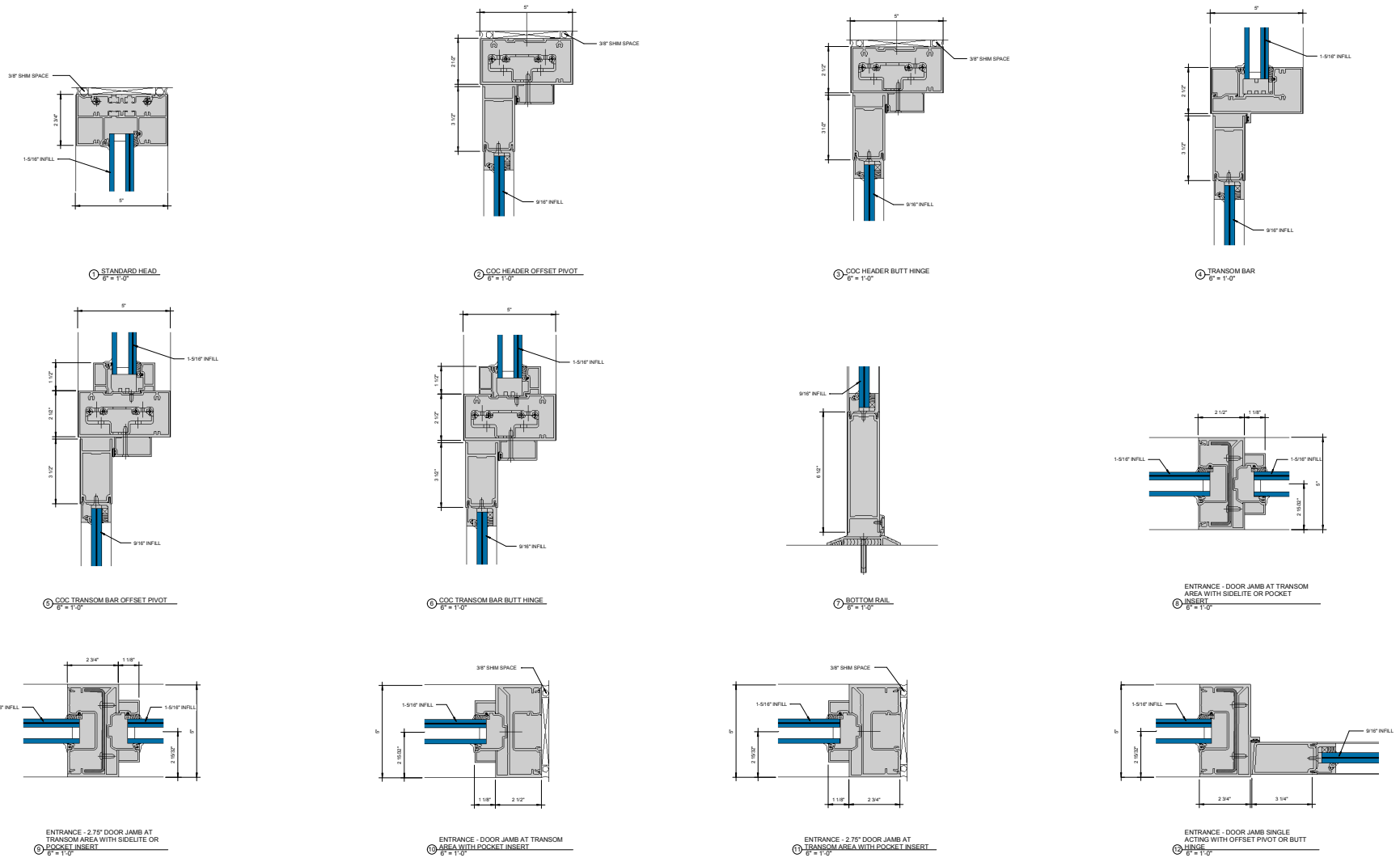



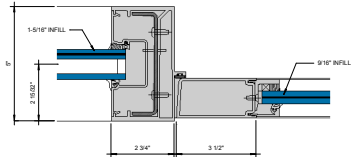

ENTRANCE - 2.75" DOOR JAMB - SINGLE ACTING WITH OFFSET PIVOT OR BUTT HINGE  
 ① 6" = 1'-0"

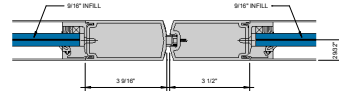

② ENTRANCE - MEETING STILE  
 6" = 1'-0"

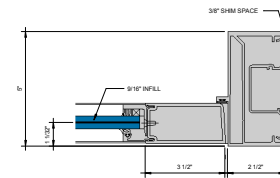

ENTRANCE - DOOR JAMB SINGLE ACTING WITH OFFSET PIVOT OR BUTT HINGE  
 ① 6" = 1'-0"

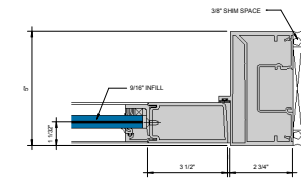

ENTRANCE - 2.75" DOOR JAMB - SINGLE ACTING WITH OFFSET PIVOT OR BUTT HINGE  
 ② 6" = 1'-0"

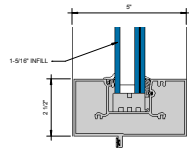

1 PIECE HEADER OR TRANSOM BAR WITH FIN  
5" x 1 1/2"

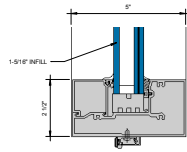

2 PIECE HEADER OR TRANSOM BAR  
5" x 1 1/2"

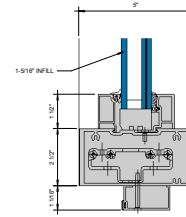

HW GOC TRANSOM BAR OFFSET PIVOT  
5" x 1 1/2"

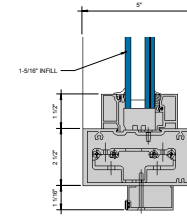

HW GOC TRANSOM BAR BUTT HINGE  
5" x 1 1/2"

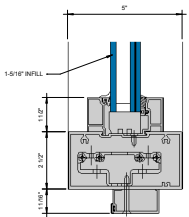

GOC TRANSOM BAR OFFSET PIVOT  
5" x 1 1/2"

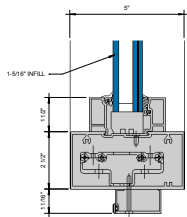

GOC TRANSOM BAR BUTT HINGE  
5" x 1 1/2"

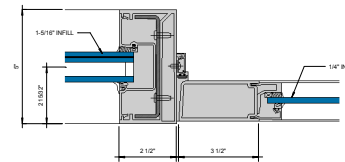

OPTIONAL DOOR JAMBS  
5" x 1 1/2"